

Sturmey
Archer 



...makes cycling easier

GET INTO GEAR...

Sturmey-Archer has been at the forefront of cycle component design for almost 100 years. The latest range of controls illustrated in this catalogue, demonstrate the flair and ingenuity our young designers bring to Sturmey-Archer products.

Using the best design techniques our engineers have developed innovative, reliable and exciting products for the trade and consumer alike. Index shifting was pioneered by Sturmey-Archer; who were one of the first to introduce twistgrips into its range of controls.



Circa. 1962

This leaflet has been produced to ensure that dealers and cyclists can get the best from their hub gear systems and shows, with easy to use diagrams, how to change cables and adjust the position of the control. Simple things, but often overlooked by others whose controls are not as versatile to allow individual positioning for different hand and finger sizes as well as handlebar shapes or to allow for simple cable replacement.

Sturmey-Archer components are made for quality cycles worldwide; and designed to provide stylish, comfortable, enjoyable and safe cycling.

Get into gear with a Sturmey-Archer Control.



Circa. 1907

Twistgrips now adorn almost 50% of all cycles sold - a technique of shifting introduced by Sturmey-Archer over a quarter of a century ago and recently brought right up to date with 3, 5 and 7 speed Twistgrips.

We have now introduced the push-button control mechanism. The new push button Orion Control is beautifully styled and offers a variety of fitment positions to suit all handlebar types. It is also fun to use and looks good.



Circa. 1966



3 speed controls

Power at your fingertips



Stanza - HSJ 835

A modern easy to operate thumbshifter control for use on bicycles fitted with all 3 speed hubs.



Orion - HSJ 865

Modern, handsome control providing easy gear operation with lever action down the gears and a slick, smooth push-button return action.



Nimbus - HSJ 823

Specifically designed to control the Sturmey-Archer range of brake hubs. Smart thumbshifter action gives positive gear selection in all gears, in all weathers.



Classic Trigger - HSJ 762 (22.2mm clip) - HSJ 765 (23.8mm clip)

The most widely used 3 speed hub gear control in the world - of long proven reliability. A quick 'flick' action, handlebar fitting control - neat, simple and trouble-free. Universally acceptable for all makes of bicycles.



Twistgrip - HSJ 880

With this control a simple twist of the wrist ensures quick, smooth indexed gear changes. Ensuring you are always in control.

Stanza, Nimbus and Orion controls are fitted with a base unit which allows them to be used in front or behind the handlebar. Precise 'teeth' allow the control's position to be set for different hand sizes.



5 speed controls

Modern controls with all the advantages of the 3 speed range.



Standard Trigger - HSJ 839

This thumbshifter control allows precise, exact gear selection. Choose the gear and select it first time everytime. Clear, concise numbering takes the 'guesswork' out of gear selection.



Orion - HSJ 866

Like the 3 speed Orion, this stylish, attractive control enhances any handlebar. Its novel push-button control makes gear selection easy. Very popular with female riders.



Twistgrip - HSJ 875

Sturmey-Archer were one of the first manufacturers to use twistgrips some 30 years ago. This model offers a rugged grip to ensure gear selection is positive even in the wet. No slipping, no fuss.



7 speed controls

A control for every handlebar type.



Standard Trigger - HSJ 845

7 speed thumbshifter with Sturmey-Archer patent handlebar detent device. This control will grace any cycle.



Twistgrip - HSJ 874

Specially selected rubber compound gives a warm feel to this grip. Easy to operate even when wet.



Wishbone Trigger - HSJ 855

Specifically designed for curved roadster handlebars. This control can be operated with either lever. The flick return is so fast, you will never miss a gear!



controls and cable fitment



3 speed Stanza



3 speed Nimbus



5 speed Trigger

Control Fitment and Orientation

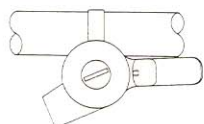

The above controls may be located either in front of or behind the handlebar. Proceed as follows:-

1. Use a socket spanner to remove control clip.
2. Place clip on handlebar so that the control is located as required. Fit control to clip using socket spanner (Max. Torque 5Nm.). Once positioned on the handlebar, the control may be rotated to any of six positions spaced at 10° intervals to match the user's individual preference. Follow instructions below:-
3. Insert coin in screw cover slot. Twist and lift off screw cover to reveal cross head screw. Unscrew, turning screw-driver approximately 6 turns.
4. Rotate control base to desired orientation, ensuring that control is correctly engaged and sits flat on base. Tighten cross head screw to a torque of 0.6 - 1.0 Nm.
5. Squeeze screw cover legs between finger and thumb. If necessary twist with coin to ensure correct location.

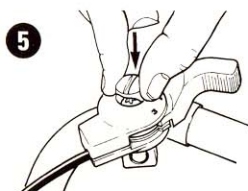
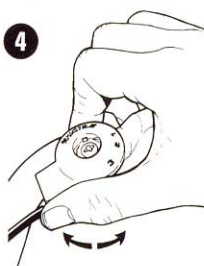
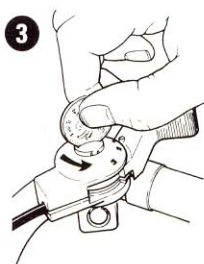
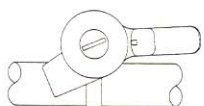

Cable Fitment

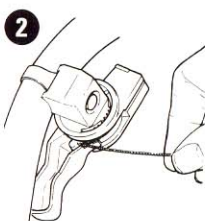

1. Select 1st gear on the control.
2. Expose cable inner wire and place nipple at base of control lever.
3. Rotate and pull cable to engage nipple in control and select high gear.
4. Push outer casing into control recess.
5. Attach cable to frame.

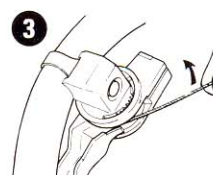

6. **3 speed** - Screw indicator into the hub and attach cable inner wire to indicator via cable anchorage.

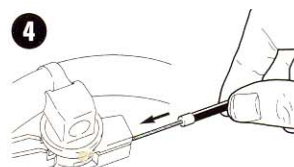

- 5 **speed** - Connect cable anchorage to fulcrum lever and cable at the hub by screwing the cable connector on to the indicator coupling.

7. Adjust the gears as described in the appropriate technical leaflet.



3 speed Trigger

Control Fitment

Open clip and place control approximately 50mm from end of handlebar grip and secure fixing screw.

Cable Fitment

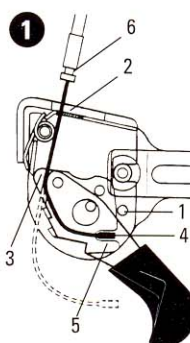

1. Pull lever back beyond bottom gear position to stop (1) and insert wire through hole (2) and between pawl and ratchet plate at (3). Wire nipple (4) is then fitted into notch (5) and cable ferrule (6) slotted into hole (2). Keeping tension on wire, push lever forward into top gear position. Control is then ready for re-connection.

2. Check that the fulcrum clip is secured tightly to the frame tube, approximately 125mm from the axle.

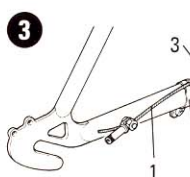

3. Pass inner wire (1) through fulcrum clip (2) and push outer cable (3) into fulcrum clip stop.
4. Loosely connect cable anchorage to inner wire, ensuring the inner wire is correctly inserted.

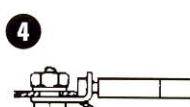

5. With control in 3rd gear connect the adjuster to the indicator coupling.
6. Take up any slackness in the inner cable and tighten cable anchorage nut.
7. Adjust gear as described in the appropriate technical leaflet.

3 speed Orion

5 speed Orion

Control Fitment and Orientation

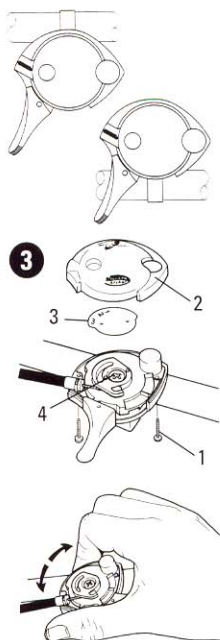

The above controls may be located either in front of or behind the handlebar. Proceed as follows:-

1. Use a socket spanner to remove control clip.
2. Place clip on handlebar so that the control is located as required. Fit control to clip using socket spanner (Max. Torque 5Nm.). Once positioned on the handlebar, the control may be rotated to any of six positions spaced at 10° intervals to match the user's individual preference. Follow instructions below:-
3. Unscrew the two cover screws (1) and remove control cover (2). Remove dial plate (3) to reveal the control orientation screw (4). Loosen the screw but do not remove. Rotate the control to the desired position ensuring that control is correctly engaged and sits flat on base. Tighten the screw (4) 0.9Nm, replace dial plate (3) and control cover (2) and tighten screws (1).

Cable Fitment

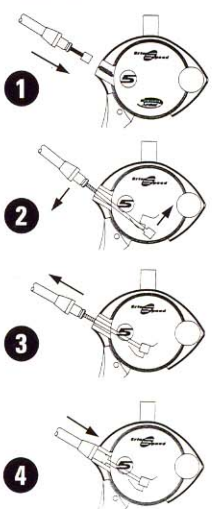

1. Feed inner cable and nipple into control.
 2. Swing cable nipple into pocket on ratchet wheel.
 3. Pull cable back to lock nipple into pocket on ratchet wheel.
 4. 'Click' locate the outer cable into control. If the outer cable does not 'click' into place check that the cover screws are tightened sufficiently.
 5. Attach cable to frame.
 6. **3 speed** - Screw indicator into the hub and attach cable inner wire to indicator via cable anchorage.
 7. **5 speed** - Connect cable anchorage to fulcrum lever and cable to the hub by screwing the cable connector onto the indicator coupling.
- Adjust the gears as described in the appropriate technical leaflet.

3 speed Twistgrip

Control Fitment

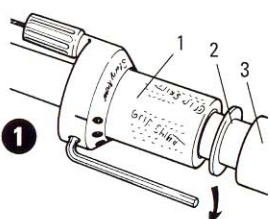

1. Slide control (1) onto handlebar followed by the washer (2) and the handlebar grip (3). Before securing control to handlebar ensure that the grip is pushed fully onto the handlebar. Now push control unit against the grip, rotate to the required position and tighten the grub screw to 2Nm max.

Cable Fitment

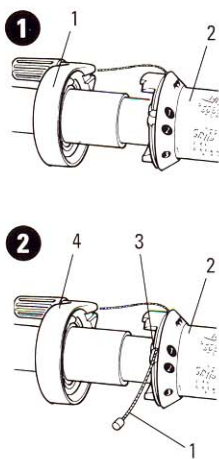

1. To replace the cable loosen grub screw in control and separate the twistgrip (1) from the body (2) by pulling apart firmly.
2. Feed inner wire (1) into twistgrip (2) and locate nipple into recess (3). Feed inner wire into body (4) and push twistgrip into body, aligning gear 3 position with mark on body to do so.
3. Thread inner wire into outer cable and secure to frame.
4. Fit cable anchorage and with control in gear 3 connect to indicator coupling.
5. Re-adjust gears.



7 speed Standard Trigger



7 speed Wishbone Trigger

Control Fitment and Orientation

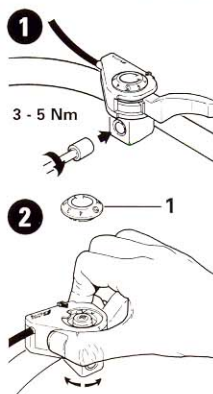

1. Fit control set in 1st gear onto RH side of handlebar and tighten bolt to 3 - 5 Nm.
2. The control orientation can be altered to suit individual needs by removing the plastic screw cover (1) at the control centre, and loosening the cross head screw. Rotate the control to the desired position before tightening the screw and replacing the cover. The control can be positioned either in front or behind the handlebar.

Cable Fitment

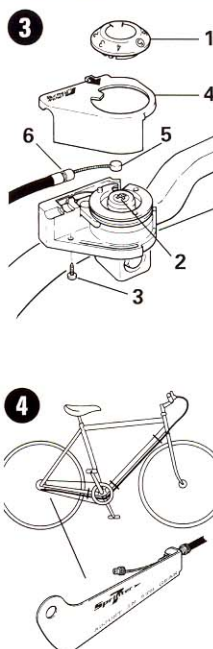

1. Select 1st Gear.
2. Expose inner cable.
3. Remove control orientation screw cover (1), do not loosen the control orientation screw (2). Undo the small cross head screw (3) on underside of control and lift off plastic panel (4) from the top of the control. Engage inner cable nipple (5) into the nipple recess in the control pulley then engage the outer cable (6) in the cable recess. Replace the top panel (4) and secure with screw (3) then replace control orientation screw cover (1).
4. Run cable along frame and secure with clips/ties. Do not fasten too tight - the outer cable should be retained but not clamped. Smallest possible cable bend 100mm radius. Fit fulcrum lever to cable by screwing in the adjuster.



5 speed Twistgrip



7 speed Twistgrip

Control Fitment

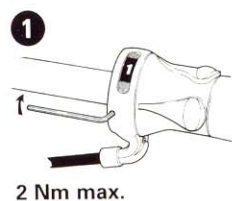

1. Slide control onto handlebar followed by the two washers and the handlebar grip. Before securing control to handlebar ensure that the grip is pushed fully onto the handlebar. Now push control unit against the grip, rotate to the required position and tighten the grub screw to 2Nm max.

Cable Fitment

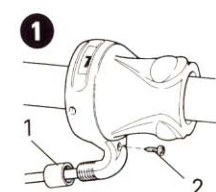

1. Remove endcap (1) and small screw (2).
2. Remove endplate.
3. Pull out twistgrip and disconnect cable nipple.
4. Thread endcap over cable.

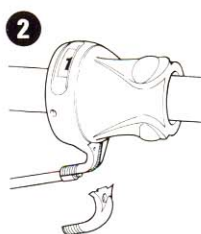

5. Insert cable nipple into nipple recess of inner dial ensuring inner wire exits control body correctly. Hold in position with thumb. Fit twistgrip onto body and rotate until it locates over cable nipple. Click twistgrip into body.

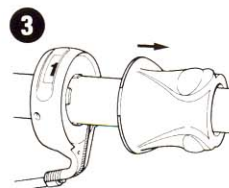

6. Insert endplate (1) ensuring the outer cable ferrule end is retained. Screw on endcap (2) and insert screw (3) and tighten.

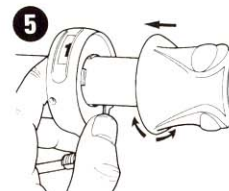

7. Re-adjust hub.

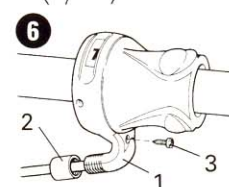

cables and indicators

Control Cables

3 Speed Cables

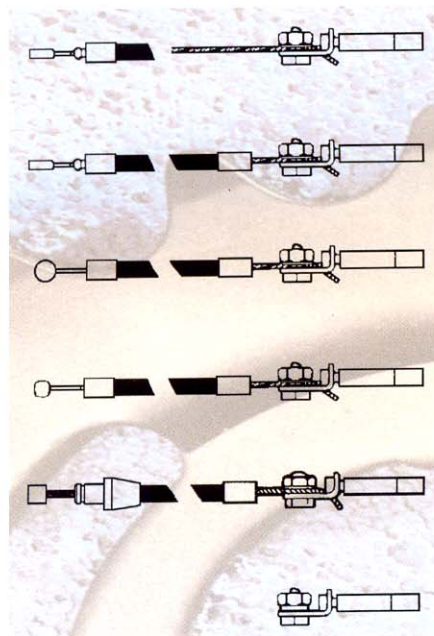
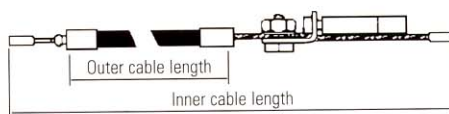

- | | |
|---------|---|
| HSJ 101 | Trigger cable complete with cable anchorage 530mm x 1520mm |
| HSJ 102 | Trigger cable complete with cable anchorage 1420mm x 1570mm |
| HSJ 884 | NIMBUS cable complete with cable anchorage 1420mm x 1570mm |
| HSJ 882 | Twistgrip cable complete with cable anchorage 1420mm x 1570mm |
| HSJ 883 | Orion cable complete with cable anchorage 1420mm x 1570mm |
| HSL 759 | Cable Anchorage |

3 and 5 Speed Cables (Sturmey-Archer fulcrum lever fitting)



HSJ 886 Control cable complete 1420mm x 70mm gauge length

HSJ 887 Orion cable complete 1420mm x 70mm gauge length

5 Speed Cable



HSJ 873 Twistgrip cable complete 1500mm x 110mm gauge length

7 Speed Cables



HSJ 847 Trigger cable complete 1450mm x 113mm gauge length



HSJ 872 Twistgrip cable complete 1500mm x 140mm gauge length

Brake Cables (for use with Sturmey-Archer Delrin brake levers)

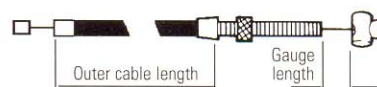

HSK 695 Front brake cable - 900mm (BFC)



HSK 698 Rear brake cable closed end - 1570mm (ABC)



HSK 713 Rear brake cable closed end - 1570mm (ST, AT3, AT5, AT7, SAB, SBR)



HSK 711 Front brake cable closed end - 940mm (SBF, VT)



HSK 714 Rear brake cable open end - 1600mm (ABC, ST, AT3, AT5, AT7, SAB, SBR)



HSK 712 Front brake cable open end - 900mm (SBF, VT)

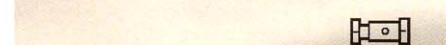

HSK 715 Pinch bolt

Brake Lever



PKL 205 Delrin brake lever - 22.2mm Ø

Indicators

ACTUAL SIZE

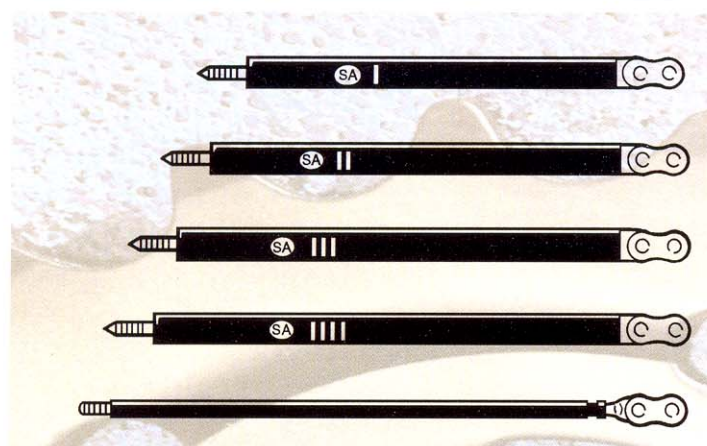

Sales No.	Description
HSA 125	AW (146mm Axle)
HSA 126	AW (163mm Axle), AWC (152mm Axle), (SAB, ABC, AT3 (before 6.89)
HSA 315	SAB, ABC, AT3 (after 6.89)
HSA 316	AWC (163mm Axle)
HSA 490	Sprinter



HSL 711 Indicator Guard

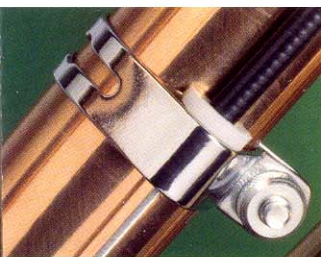

fulcrum clips and pulleys

Fulcrum Clips - Top tube and down tube

ACTUAL SIZE

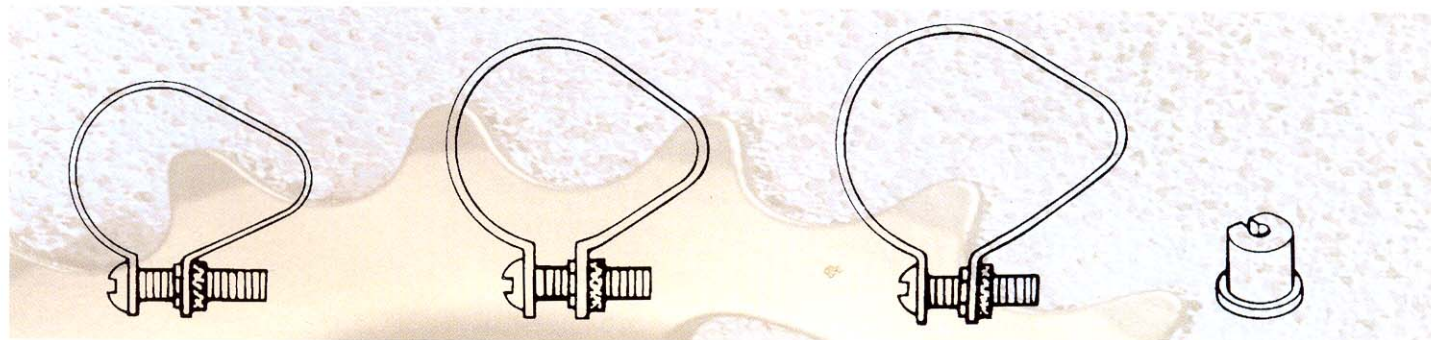

HSJ 513
22.2mm Ø

HSJ 512
25.4mm Ø

HSJ 514
28.6mm Ø

HSJ 515
Fulcrum Sleeve

Fulcrum Clips - Chainstay and backstay

ACTUAL SIZE

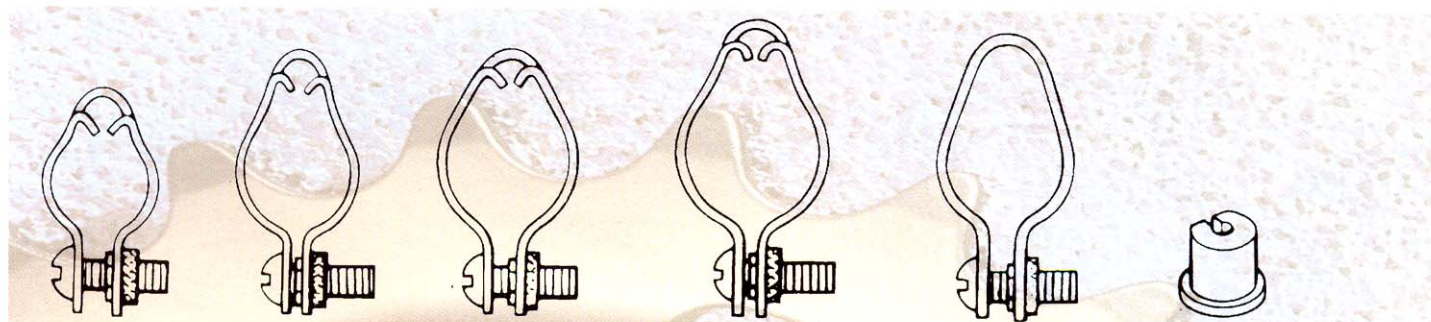

HSJ 607
12.7mm Ø

HSJ 553
15.9mm Ø

HSJ 548
17.9mm Ø

HSJ 753
19.1mm Ø

HSJ 775
15.9mm Ø

HSJ 515
Fulcrum Sleeve

Pulleys - Top tube and down tube

ACTUAL SIZE

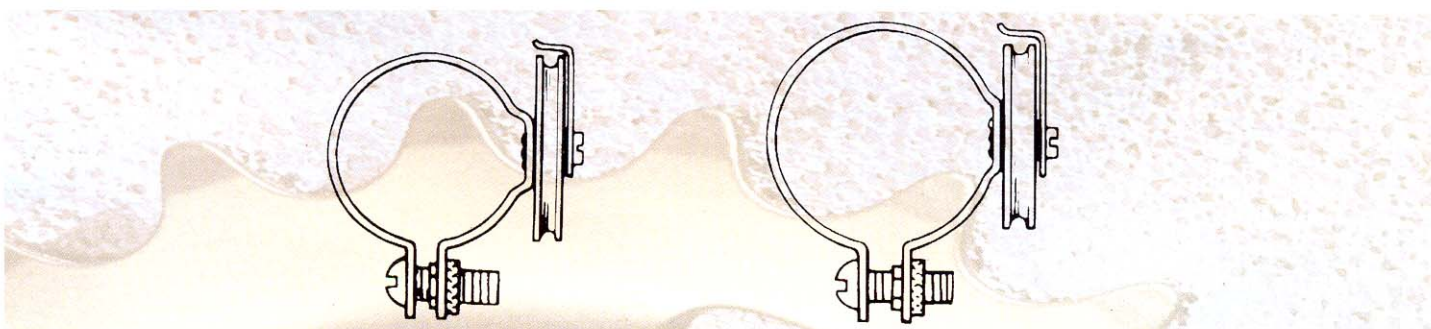

HSJ 520
25.4mm Ø

HSJ 521
28.6mm Ø



brake arm clips

Front brake arm clips

ACTUAL SIZE

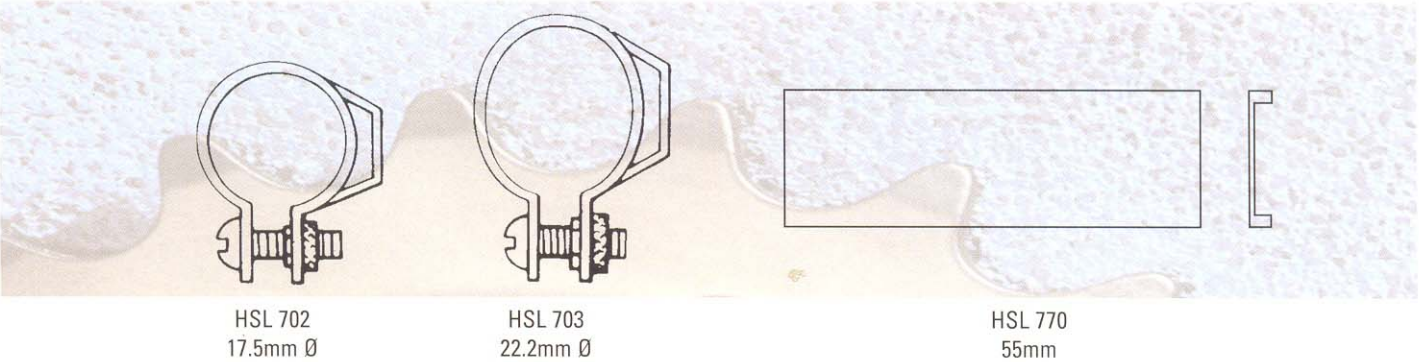

Rear brake arm clips

ACTUAL SIZE

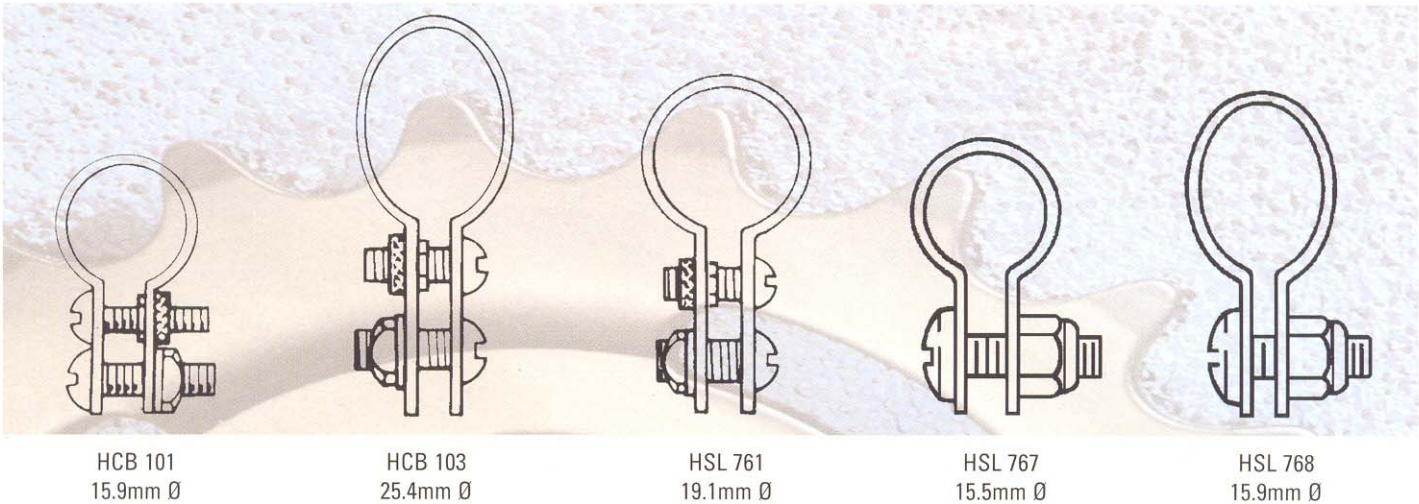

sprockets

14 - 16

17 - 21

22

Sales No. Description

HSL 714	14Teeth
HSL 715	15Teeth
HSL 716	16Teeth
HSL 717	17Teeth (dished)
HSL 718	18Teeth (dished)
HSL 719	19Teeth (dished)
HSL 720	20Teeth (dished)
HSL 747	21Teeth (dished)
HSL 722	22Teeth (dished)

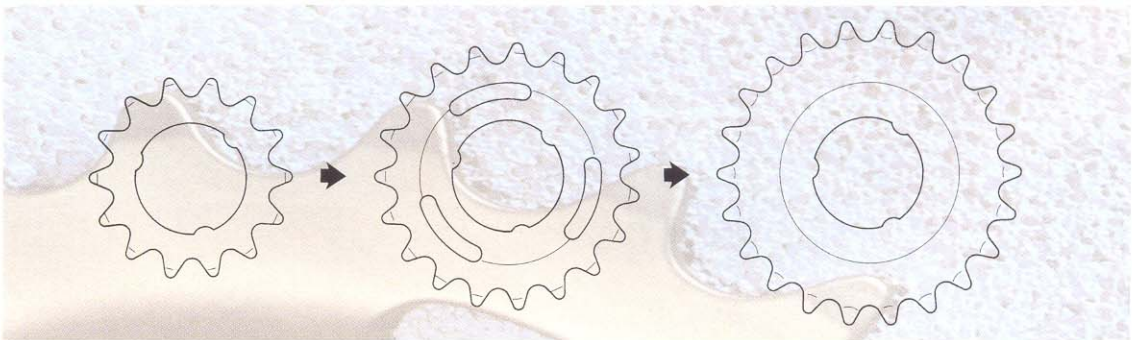



fulcrum levers and selector guides

Fulcrum Levers



HSJ 844 - Fulcrum lever for 7 speed hubs



HSJ 842 - Fulcrum lever for 3 and 5 speed hubs

Selector Guides



HSA 488 - Gear selector guide for 5 speed hubs



HSJ 848 - Cable Drum
HSJ 850 - Adjuster Cover

HSJ 864 - Left Hand Grip



HSJ 863 - Right Hand Grip



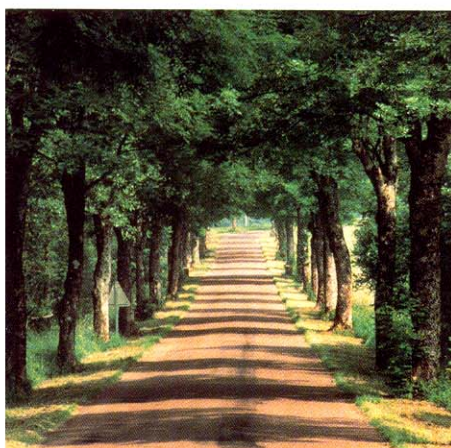

Sturmey-Archer Ltd., Triumph Road, Nottingham NG7 2GL, England.
Tel: 0115 942 0800 Fax: 0115 942 0801

Exclusive UK Distributors: Raleigh Parts and Accessories
Tel: 0115 942 0202 Fax: 0115 928 2044

Persons Majestic MFG., 21 Hamilton Street, MONROEVILLE, OHIO 44847 U.S.A.
Tel: (419) 465-2504 Fax: (419) 465-4070

REPRESENTED THROUGHOUT THE WORLD